

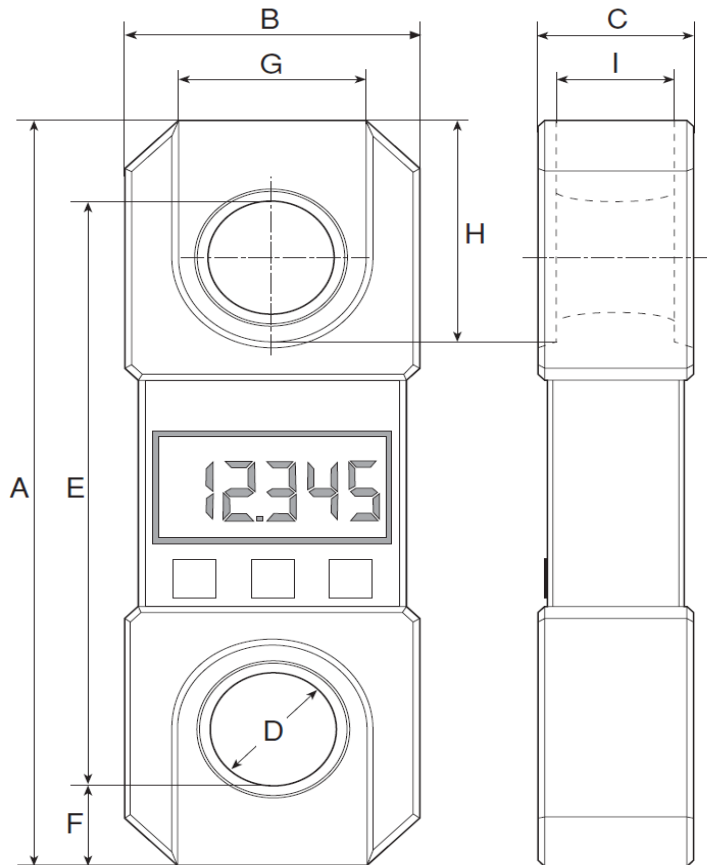

Dimensjoner veiecelle strekk [mm]/ *Dimensions tension load cell [mm]*

Kapasitet/ <i>Capacity</i>	A	B	C	D	E	F	G	H	I
50 t	440	164	98	72	332	54	104	142	86



kabellengde/ *cable length* : 44 m

Vekt/ *weight*: 15,1 kg